



Chesterton Road, Cambridge, CB4 1AA



# Chesterton Road

Cambridge,  
CB4 1AA

A well presented 1 bedroom lower ground floor apartment boasting an array of original period features and located on Mitchams Corner. The accommodation comprises entrance hall, living room, kitchen, study, 1 double bedroom and shower room. Communal courtyard with bicycle railings. Unfurnished. Available from 24/07/2026. EPC: D and Council Tax Band: C.

## LOCATION

The property is located on Mitcham's Corner in the West Chesterton ward of Cambridge. It is positioned a short distance from the River Cam, Midsummer Common and Jesus Green. The property benefits from an excellent range of local amenities nearby and offers convenient access to the historic city centre and Cambridge Science Park.



£1,275 PCM





## ENTRANCE HALL

Into:

## LIVING ROOM

Bay window to front aspect, feature fireplace (not in use). Door to shower room and archway to:

## INNER HALLWAY

The bedroom and kitchen are accessed off the inner hallway.

## KITCHEN

Base and wall units, work tops, sink with window to side aspect above, oven, gas hob with extractor above and integrated appliances including fridge freezer, dishwasher and washer dryer. Door to:

## STUDY

Window to side aspect.

## BEDROOM

Window to rear aspect.

## SHOWER ROOM

Shower enclosure, wc, wash basin with mirror above and glass block window to side aspect.

## LETTING AGENT NOTES

For more information on this property please refer to the Material Information brochure on our Website.

Holding Deposit - £294

Deposit - £1471



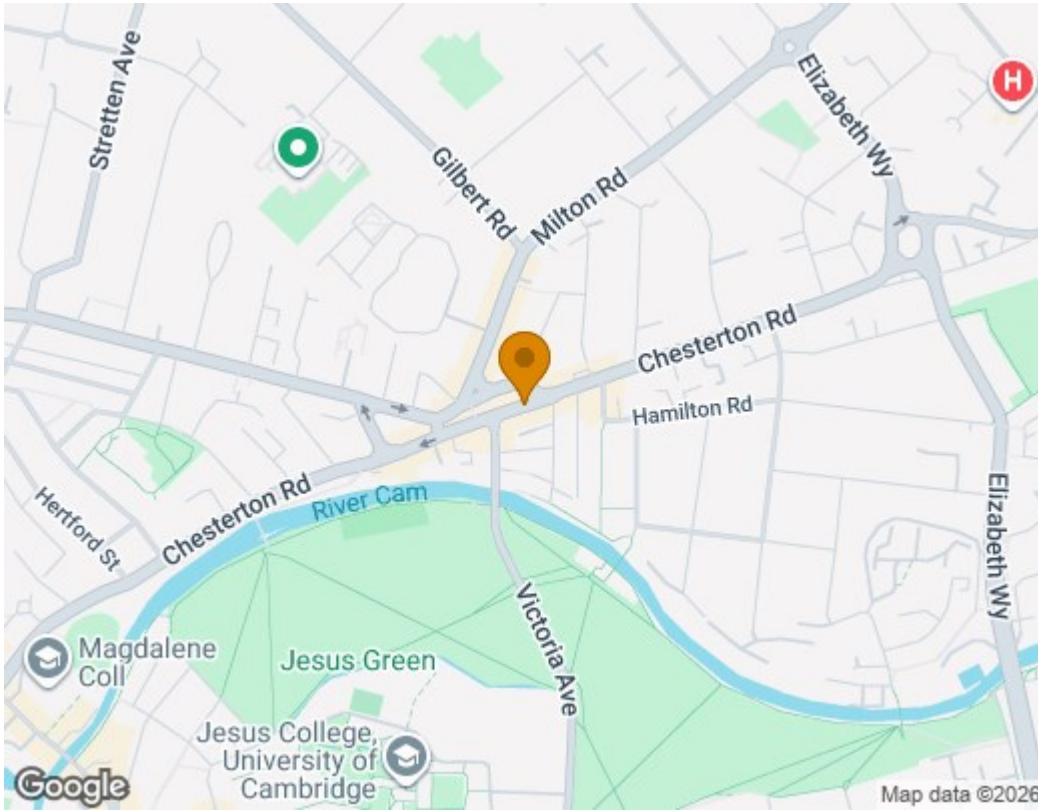

## Lower Ground Floor

Approx. 48.6 sq. metres (522.7 sq. feet)

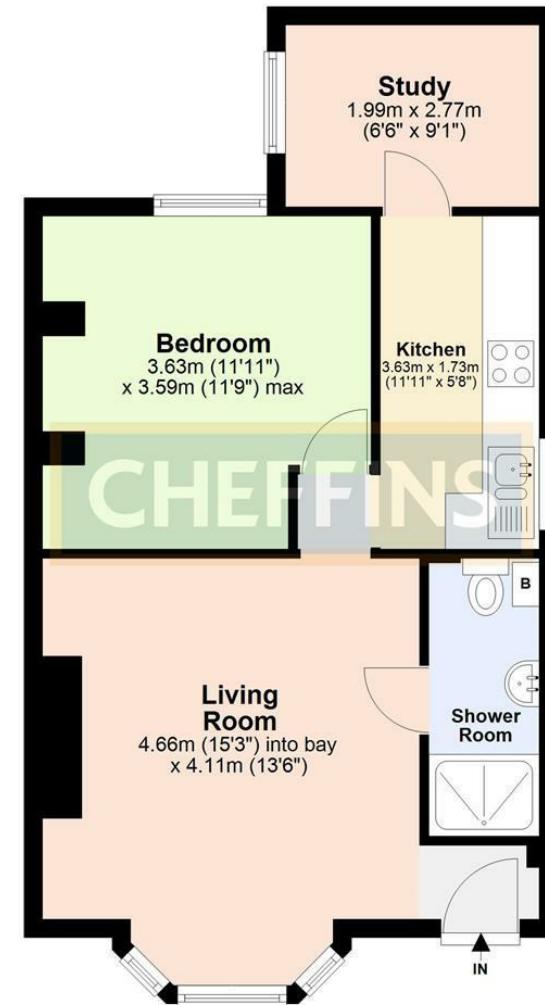

Total area: approx. 48.6 sq. metres (522.7 sq. feet)

Energy Efficiency Rating	
Current	Potential
Very energy efficient - lower running costs	
(92-100) A	
(81-91) B	
(69-80) C	
(55-68) D	
(39-54) E	
(21-38) F	
(1-20) G	
	76
	66
Not energy efficient - higher running costs	
England & Wales	
EU Directive 2002/91/EC	

Agents note:  
For more information on this property please refer to the Material Information Brochure on our website.

Clifton House, 1-2 Clifton Road, Cambridge, Cambridgeshire, CB1 7EA | 01223 271916 | cheffins.co.uk

IMPORTANT: we would like to inform prospective purchasers that these sales particulars have been prepared as a general guide only. A detailed survey has not been carried out, nor the services, appliances and fittings tested. Room sizes should not be relied upon for furnishing purposes and are approximate. If floor plans are included, they are for guidance only and illustration purposes only and may not be to scale. If there are any important matters likely to affect your decision to buy, please contact us before viewing the property.

